

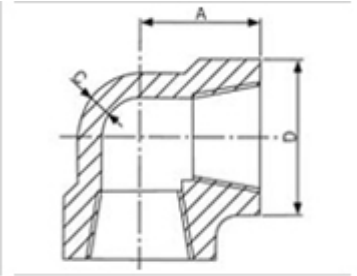

Threaded Elbow, Tee and Cross

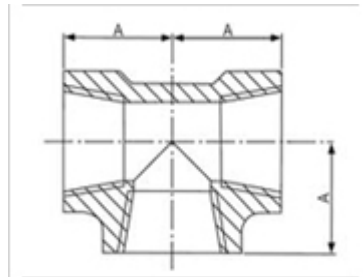

90° Elbow



Tee

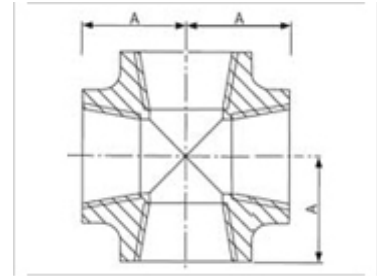

Cross

公称通径		中心至端面 Center to End						外径			壁厚			螺纹长度	
Nominal Diameter		A						Outside Diameter D			Wall Thickness			Length of Thread	
		弯头、三通、四通			45°弯头			D			Cmin				
		Elbow、Tee、Cross			45°Elbow										
		DN	NPS	2000LB	3000LB	6000LB	2000LB	3000LB	6000LB	2000LB	3000LB	6000LB	2000LB		
		Sch80	Sch160	XXS	Sch80	Sch160	XXS	Sch80	Sch160	XXS	Sch80	Sch160	XXS		
6	1/8	21	21	25	17	17	19	22	22	25	3	3	6.5	6.5	6.5
8	1/4	21	25	29	17	19	22	22	25	33	3	3.5	6.5	8	10
10	3/8	25	29	33	19	22	25	25	33	38	3	3.5	7	9	10.5
15	1/2	29	33	38	22	25	29	33	38	46	3	4	8	11	13.5
20	3/4	33	38	44	25	29	33	38	46	56	3	4.5	8.5	12.5	14
25	1	38	44	51	29	33	35	46	56	62	3.5	5	10	14.5	17.5
32	1.1/4	44	51	60	33	35	43	56	62	75	4	5.5	10.5	17	18
40	1.1/2	51	60	64	35	43	44	62	75	84	4	5.5	11	18	18.5
50	2	60	64	83	43	45	52	75	84	102	4.5	7	12	19	19
65	2.1/2	76	83	95	52	52	64	92	102	121	5.5	7.5	15.5	23.5	29
80	3	86	96	106	64	64	79	110	121	146	6	9	16.5	26	30
100	4	106	114	114	79	79	79	146	152	152	6.5	11	18.5	27.5	33

Above sizes are in accordance with ASME B16.11, BSP3799 and GB/T14626.



Socket Welding Elbow, Tee and Cross

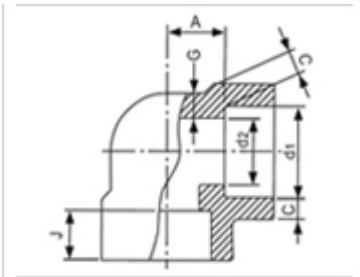

90° Elbow

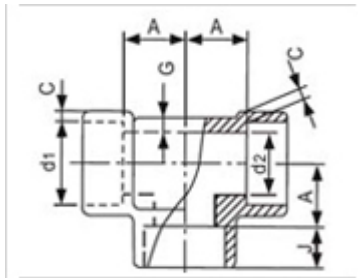

Tee

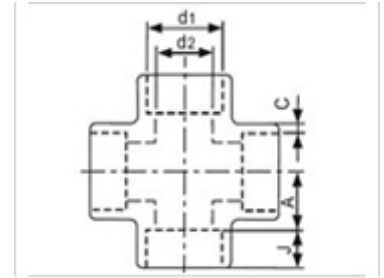

Cross

公称通径		承插孔深度	承插孔直径	壁厚			中心至承插孔底					
Nominal Diameter		Depth of Socket	Dimension of Socket	Wall Thickness			Center to Bottom of Socket					
							A					
				Cmin			90°弯头、三通、四通 90°Elbow、Tee、Cross			45°弯头 45°Elbow		
DN	NPS	Jmin	d1	3000LB Sch80	6000LB Sch160	9000LB XXS	3000LB Sch80	6000LB Sch160	9000LB XXS	3000LB Sch80	6000LB Sch160	9000LB XXS
6	1/8	10	10.7	3.2	3.5	-	11	11	-	8	8	-
8	1/4	10	14.1	3.3	4	-	11	15	-	8	8	-
10	3/8	10	17.5	3.5	4.4	-	13	15	-	8	12	-
15	1/2	10	21.8	4.1	5.2	8.2	16	19	25	11	13	16
20	3/4	13	27.4	4.3	6.1	8.6	19	22	28	13	14	18
25	1	13	34.2	5	7	10	22	27	32	14	18	22
32	1.1/4	13	42.9	5.3	7	10.6	27	32	35	18	21	22
40	1.1/2	13	48.3	5.6	7.8	11.2	32	38	38	21	25	25
50	2	13	61.1	6.1	9.5	12.2	38	41	41	25	29	29
65	2.1/2	16	76.9(73.8)	7.7	12.5	-	41	57	-	29	32	-
80	3	16	89.8	8.3	13.8	-	57	64	-	32	35	-
100	4	19	115.5	9.4	-	-	66	-	-	42	-	-

Above sizes are in accordance with ASME B16.11, SH3410, HG/T21634, JIS B2316, BS3799 and GB/T14383.



Coupling, Half Coupling and Cap

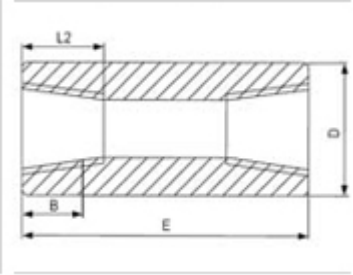

Coupling

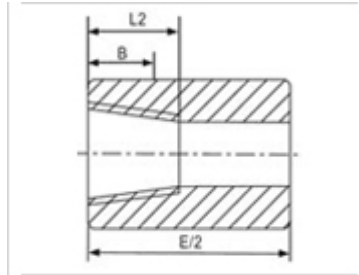

Half Coupling

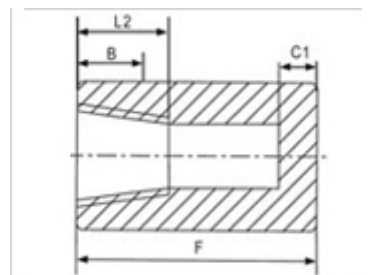

Cap

公称通径		管箍、管帽长度				外径		管帽顶厚		螺纹长度	
Nominal Diameter		The Length of Coupling and Cap				Outside Diameter		End Wall Thickness		Length of Thread	
		E		F		D		Cmin			
DN	NPS	3000LB Sch160	6000LB XXS	3000LB Sch160	6000LB XXS	3000LB Sch160	6000LB XXS	3000LB Sch160	6000LB XXS	B	L2
6	1/8	32	32	19	-	16	22	5	-	6.5	6.5
8	1/4	35	35	25	27	19	25	5	6.5	8	10
10	3/8	38	38	25	27	22	32	5	6.5	9	10.5
15	1/2	48	48	32	33	29	38	6.5	8	11	13.5
20	3/4	51	51	37	38	35	44	6.5	8	12.5	14
25	1	60	60	41	43	44	57	9.5	11	14.5	17.5
32	1.1/4	67	67	44	46	57	64	9.5	11	17	18
40	1.1/2	76	76	44	48	64	76	11	12.5	18	18.5
50	2	86	86	48	51	76	92	12.5	16	19	19
65	2.1/2	92	92	60	64	92	108	16	19	23.5	29
80	3	108	108	65	68	108	127	19	22	26	30.5
100	4	121	121	68	75	140	159	22	28.5	27.5	33

Above sizes are in accordance with ASME B16.11, BS3799 and GB/T14626.



Coupling, Half Coupling and Cap

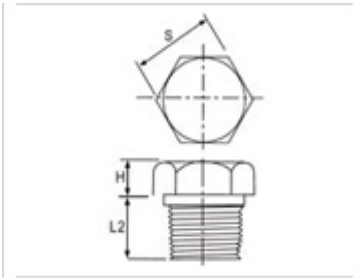

Hex Head Plug

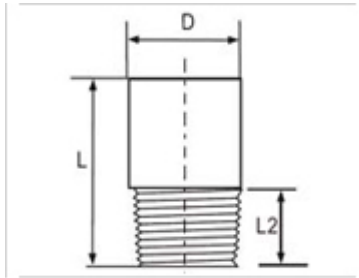

Round Head Plug

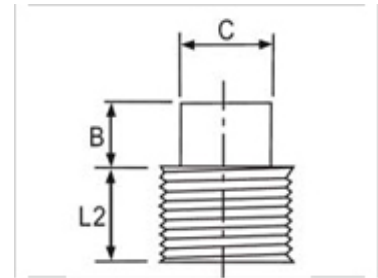

Square Head Plug

公称通径		螺纹长度	方头管塞		圆头管塞		六角头管塞和接头		
Nominal Diameter		Length of Thread	Square Head Plug		Round Head Plug		Hex Head Plug and Bushing		
			方头高度	平面宽度	圆头直径	全长	平面宽度	六角头高度	
DN	NPS	L2min	Height of Square	Width Of Flats	Diameter of Round Head	Length	Width Of Flats	Hex Head Height	
			Bmin	Cmin	D	Lmin	S	Kmin	Hmin
6	1/8	9.5	6	7	10	35	11	-	6
8	1/4	11	6	9.5	13	41	16	3	6
10	3/8	12.5	8	11	17	41	17.5	4	8
15	1/2	14.5	10	14.5	21	44	22	5	8
20	3/4	16	11	16	27	44	27	6	10
25	1	19	13	20.5	33	51	35	6	10
32	1.1/4	20.5	14	24.5	43	51	44.5	7	14
40	1.1/2	20.5	16	28.5	48	51	51	8	16
50	2	22	17	33.5	60	64	63.5	9	17
65	2.1/2	27	19	38	73	70	76	10	19
80	3	28.5	21	43	89	70	89	10	21
100	4	32	25	63.5	114	76	117.5	13	25

Above sizes are in accordance with ASME B16.11, BS3799 and GB/T14626.



Hex Nipple and Reducing Hex Nipple

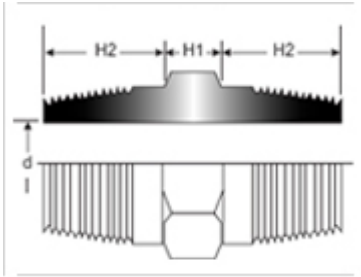

Hex Nipple

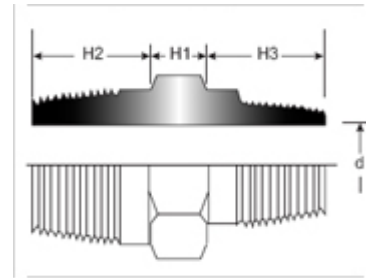

Reducing Hex Nipple

公称通径		尺寸					
Nominal Diameter		Size					
DN	NPS	C	E1	E2	W	D	
						sch80	sch160
6	1/8	6	10	---	26	5	4
8	1/4	6	15	---	36	7	6
8×6	1/4×1/8	6	15	10	31	5	4
10	3/8	8	16	---	40	10	8
10×8	3/8×1/4	8	16	15	39	7	6
15	1/2	8	20	---	48	13	10
15×10	1/2×3/8	8	20	16	44	10	8
15×8	1/2×1/4	8	20	15	43	7	6
20	3/4	10	21	---	52	18	14
20×15	3/4×1/2	10	21	20	51	13	10
20×10	3/4×3/8	10	21	16	47	10	8
25	1	10	25	---	60	23	19
25×20	1×3/4	10	25	21	56	18	14
25×15	1×1/2	10	25	20	55	13	10
32	1.1/4	12	25	---	62	31	28
32×25	1.1/4×1	12	25	25	62	23	19
32×20	1.1/4×3/4	12	25	21	58	18	14
32×15	1.1/4×1/2	12	25	20	57	13	10
40	1.1/2	16	26	---	68	36	32
40×32	1.1/2×1.1/4	16	26	25	67	31	28
40×25	1.1/2×1	16	26	25	67	23	19

公称通径		尺寸					
Nominal Diameter		Size					
DN	NPS	C	E1	E2	W	D	
						sch80	sch160
40×20	1.1/2×3/4	16	26	21	63	18	14
40×15	1.1/2×1/2	16	26	20	62	13	10
50	2	18	27	---	72	47	40
50×40	2×1.1/2	18	27	26	71	36	32
50×32	2×1.1/4	18	27	25	70	31	28
50×25	2×1	18	27	25	70	23	19
50×20	2×3/4	18	27	21	66	18	14
50×15	2×1/2	18	27	20	65	13	10
65	2.1/2	20	38	---	96	57	51
65×50	2.1/2×2	20	38	27	85	47	40
65×40	2.1/2×1.1/2	20	38	26	84	36	32
65×32	2.1/2×1.1/4	20	38	25	83	31	28
65×25	2.1/2×1	20	38	25	83	23	19
65×20	2.1/2×3/4	20	38	21	79	18	14
80	3	20	40	---	100	70	63
80×65	3×2.1/2	20	40	38	98	57	51
80×50	3×2	20	40	27	87	47	40
80×40	3×1.1/2	20	40	26	86	36	32
80×32	3×1.1/4	20	40	25	85	31	28
80×25	3×1	20	40	25	85	23	19

The standard thread type is NPT, if other types are required, please specify it in the P.O..



Threaded Union & Socket Union

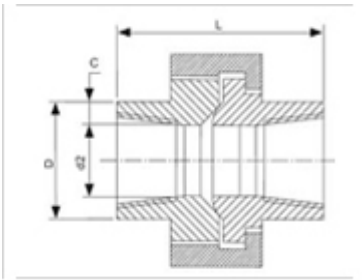

Threaded Union

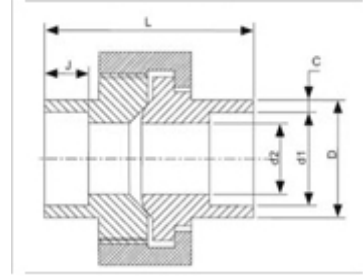

Socket Union

公称通径		外径		壁厚		承插孔径	流通孔径	承插孔深度	公称装配长度
Nominal Diameter		Outside Diameter		Wall Thickness		Socket Bore	Water way Bore	Depth of Socket	Nominal Assembly Length
		Dmin		Cmin		d1	d2	Jmin	L
DN	NPS	承插焊	螺纹	承插焊	螺纹	承插焊	承插焊、螺纹	承插焊	承插焊、螺纹
		Socket	Threaded	Socket	Threaded	Socket	Socket & Threaded	Socket	Socket & Threaded
6	1/8	21.8	14.7	3.2	2.5	10.65	6.43	10	41.4
8	1/4	21.8	19	3.3	3.1	14.1	9.45	10	41.4
10	3/8	25.9	22.9	3.5	3.2	17.55	13.51	10	46
15	1/2	31.2	27.7	4.1	3.8	21.7	17.07	10	49
20	3/4	37.1	33.5	4.3	4	27.05	21.39	13	56.9
25	1	45.5	41.4	5	4.6	33.8	27.74	13	62
32	1.1-4	54.9	50.5	5.3	4.9	42.55	35.36	13	71.1
40	1.1-2	61.5	57.2	5.6	5.1	48.65	41.2	13	76.5
50	2	75.2	70.1	6.1	5.6	61.1	52.12	16	86.1
65	2.2/1	91.7	85.3	7.7	7.1	73.8	64.31	16	102.4
80	3	109.2	102.4	8.4	7.7	89.8	77.27	16	109

1. Above sizes are in accordance with MSS SP-83 and BS3799.
2. Rating Pressure: 3000 PSI.
3. The standard thread type is NPT, if other types are required, please specify it in the enquiry.



Cap, Half Coupling and Lateral

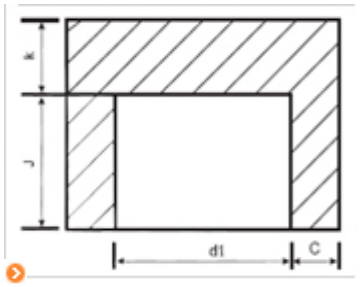

Cap

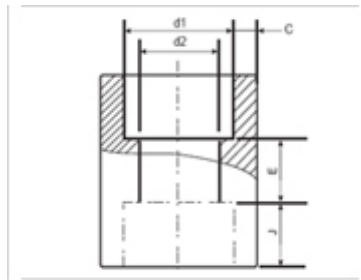

Half Coupling

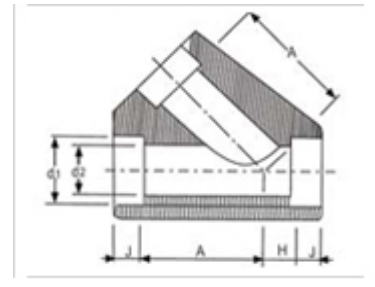

Lateral

公称通径		承插孔	承插孔	壁厚			管帽顶厚			中间长度		中心至承插孔底			
Nominal		深度	直径	Wall Thickness			End Wall Thickness			The length of midst		Center to Bottom of Socket			
Diameter		Depth of Socket	Dimension of Socket	Cmin			Kmin			双承口	单承口	45°斜三通			
										管箍	管箍	Lateral			
										Coupling	Half-Coupling				
												A		H	
DN	NPS	Jmin	d1	3000LB	6000LB	9000LB	3000LB	6000LB	3000LB	E	F	3000LB	6000LB	3000LB	6000LB
				Sch80	Sch160	XXS	Sch80	Sch160	XXS			Sch80	Sch160	Sch80	Sch160
6	1/8	10	10.7	3.2	3.5	-	5	6.5	-	6	16	-	-	-	-
8	1/4	10	14.1	3.3	4	-	5	6.5	-	6	16	32	-	8	-
10	3/8	10	17.5	3.5	4.4	-	5	6.5	-	6	17	37	-	8	-
15	1/2	10	21.8	4.1	5.2	8.2	6.5	8	11	10	22	41	51	11	13
20	3/4	13	27.4	4.3	6.1	8.6	6.5	8	12.5	10	24	51	60	13	14
25	1	13	34.2	5	7	10	9.5	11	14	13	29	60	71	14	18
32	1.1/4	13	42.9	5.3	7	10.6	9.5	11	14	13	30	71	81	18	21
40	1.1/2	13	48.3	5.6	7.8	11.2	11	12.5	16	13	32	81	98	21	25
50	2	13	61.1	6.1	9.5	12.2	12.5	16	19	19	41	98	120	25	29
65	2.1/2	16	76.9(73.8)	7.7	12.5	-	16	19	-	19	43	-	-	-	-
80	3	16	89.8	8.3	13.8	-	19	22	-	19	45	-	-	-	-
100	4	19	115.5	9.4	-	-	22	28.5	-	19	48	-	-	-	-

Above sizes are in accordance with ASME B16.11, GB/T14383, SH3410, HG/T21634, JIS B2316, BS3799.



Concentric Swage Nipple and Eccentric Swage Nipple

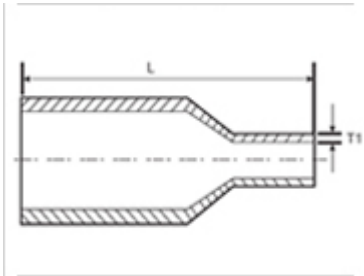

Concentric Swaged Nipple

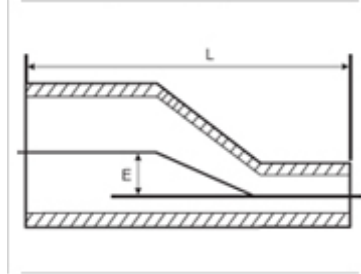

Eccentric Swaged Nipple

公称通径 Nominal Diameter		L	E
DN	NPS		
10×8	3/8×1/4	64	1.7
15×8	1/2×1/4	70	1.9
15×10	1/2×3/8	70	1.05
20×8	3/4×1/4	76	6.5
20×10	3/4×3/8	76	4.8
20×15	3/4×1/2	76	2.7
25×8	1×1/4	89	10.2
25×10	1×3/8	89	8.6
25×15	1×1/2	89	6.5
25×20	1×3/4	89	3
32×8	1.1/4×1/4	102	14.2
32×10	1.1/4×3/8	102	12.5
32×15	1.1/4×1/2	102	10.4
32×20	1.1/4×3/4	102	7.7
32×25	1.1/4×1	102	3.9
32×8	1.1/4×1/4	114	17.3
40×10	1.1/2×3/8	114	15.6
40×15	1.1/2×1/2	114	13.5
40×20	1.1/2×3/4	114	12.6
40×25	1.1/2×1	114	6.9
40×32	1.1/2×1.1/4	114	3
50×8	2×1/4	165	23.3
50×10	2×3/8	165	21.6
50×15	2×1/2	165	19.5
50×20	2×3/4	165	16.8

公称通径 Nominal Diameter		L	E
DN	NPS		
50×25	2×1	165	13
50×32	2×1.1/4	165	9.1
50×40	2×1.1/2	165	6
65×15	2.1/2×1/2	178	25.1
65×20	2.1/2×3/4	178	23.2
65×25	2.1/2×1	178	19.4
65×32	2.1/2×1.1/4	178	15.5
65×40	2.1/2×1.1/2	178	12.4
65×50	2.1/2×12	178	6.4
80×15	3×1/2	203	33.8
80×20	3×3/4	203	31.1
80×25	3×1	203	27.3
80×32	3×1.1/4	203	23.4
80×40	3×1.1/2	203	20.3
80×50	3×2	203	14.3
80×65	3×2.1/2	203	7.9
100×15	4×1/2	229	46.5
100×20	4×3/4	229	43.8
100×25	4×1	229	40
100×32	4×1.1/4	229	36.1
100×40	4×1.1/2	229	33
100×50	4×2	229	27
100×65	4×2.1/2	229	20.6
100×80	4×3	229	12.7

1. The ends of the nipples include PLAIN, BEVEL and THREAD (The standard thread type is NPT), please specify the ends in your enquiry.
2. Wall thickness of the nipples is Schedule 80 (3000 LBS) and Schedule 160 (6000 LBS)
3. Above sizes are in accordance with MSS SP95, BS3799.



Butt-Weld Outlet and Other Outlets

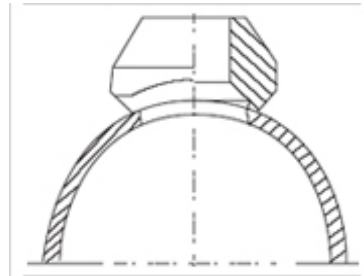
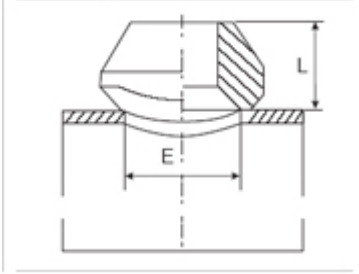

Standard: MSS SP-97、GB19326、Q/FG13

公称通径		适用主管公称通径		L			E		
Nominal Diameter		Nominal Diameter of Suited Main Pipe							
		≥							
mm	in	mm	in	STD	XS	XXS	STD	XS	XXS
6	1/8	20	3/4	15.9	-	-	15.9	-	-
8	1/4	20	3/4	15.9	-	-	15.9	-	-
10	3/8	25	1	19.1	-	-	19.1	-	-
15	1/2	32	1.1/4	19.1	19.1	28.6	23.8	23.8	14.3
20	3/4	40	1.1/2	22.2	22.2	31.8	30.2	30.2	19.1
25	1	40	1.1/2	27	27	38.1	36.5	36.5	25.4
32	1.1/4	65	2.1/2	31.8	31.8	44.5	44.5	44.5	33.3
40	1.1/2	65	2.1/2	33.3	33.3	50.8	50.8	50.8	38.1
50	2	80	3	38.1	38.1	58.6	65.1	65.1	42.9
60	2.1/2	100	4	41.3	41.3	61.9	76.2	76.2	54
80	3	125	5	44.5	44.5	73	93.7	93.7	77
90	3.1/2	150	6	47	47	-	101.6	101.6	-
100	4	150	6	50.8	50.8	84.1	120.7	120.7	98.4
125	5	200	8	57.2	57.2	93.7	141.3	141.3	122.2
150	6	200	8	60.3	77.8	104.8	169.9	169.9	146.1
200	8	250	10	69.9	98.4	-	220.7	220.7	-
250	10	300	12	77.8	93.7	-	274.6	265.1	-
300	12	350	14	85.7	103.2	-	325.4	317.5	-
350	14	400	16	88.9	100	-	357.2	350.9	-
400	16	450	18	93.7	106.4	-	408	403.2	-
450	18	500	20	96.8	111.1	-	458.8	455.6	-
500	20	600	24	101.6	119.1	-	508.8	509.6	-
600	24	650	26	115.9	139.7	-	614.4	614.4	-

Other than Butt-Weld Outlet, we also provide Socket-Weld Outlet, Thread Outlet, 45° Outlet and Nipolet. Please contact us for more information by sending email to fittingsupply@hotmail.com.